

Lever Action Rifle



Model 1885 High Wall

IMPORTANT: When ordering, list part number, part name, gun gauge/caliber and serial number. Please specify grade. Prices F.O.B. point of shipment — subject to change without notice. Prices effective January 1, 2024.

Ref. #	Part #	Description
5	B3474733	BUTT PLATE SCREW (45-70)
5	B3474628	BUTT PLATE SCREW, TRADITIONAL
6	* B3474742	DEFLECTOR
6	* U3474632	DEFLECTOR, WSM, TRADITIONAL
7	B3474744	DEFLECTOR BALL
8	B3474746	DEFLECTOR BALL SPRING
9	* B3474750	EJECTOR CONNECTING PIN
10	* B3474753	EJECTOR HAMMER
11	* B3474756	EJECTOR HAMMER EXTENTION
11	* B3474757	EJECTOR HAMMER EXTENTION, BPCR
12	* B3474759	EJECTOR HAMMER EXTENTION WASHER
13	* B3474761	EJECTOR HAMMER SEAR
14	* B3474763	EJECTOR HAMMER SEAR PIN
15	* B3474765	EJECTOR HAMMER SPRING
16	* B3474767	EJECTOR HAMMER SPRING GUIDE
17	* B3474625	EXTRACTOR, (45-70)
17	* B3474769	EXTRACTOR, 223REM
17	* B3474768	EXTRACTOR, 270, 30-06/22-250
17	* B3474636	EXTRACTOR, 30-30/38-55 TRADITIONAL
17	* B3474943	EXTRACTOR, 44 MAG/45 COLT TRADITIONAL
17	* B3474775	EXTRACTOR, 45-70 HI-WALL & TRADITIONAL
17	* B3474773	EXTRACTOR, 7MM MAG ONLY
17	* U3474646	EXTRACTOR, WSM ('05)
18	* B3474774	EXTRACTOR, SPRING
19	* B3474776	EXTRACTOR, SPRING PLUNGER
20	* B3474780	FIRING PIN
21	* B3474783	FIRING PIN BUSHING
22	* B3474789	FIRING PIN SPRING
23	* B3474787	FIRING PIN RETAINING PIN
24	* U3474657	FOREARM, BPCR TARGET (SHOT SHOW '09)
24	* U3474648	FOREARM, CENTENNIAL HUNTER 30-06 GRADE 3
24	* U3474658	FOREARM, CREEDMOOR (DAVIDSON'S)
24	* B3474796	FOREARM, GRADE 1
24	* U3474645	FOREARM, HIGH WALL 30-06
24	* U3474644	FOREARM, HUNTER .405 WIN/45-70
24	* U3474633	FOREARM, WSM HIGH WALL TRADITIONAL
25	* B3474808	FOREARM ESCUTCHEON
26	* B3474810	FOREARM HANGER
27	* B3474812	FOREARM HANGER BOLT
29	* B3474816	FOREARM SCREW
30	B3474809	FOREARM SLING EYELET
35	* B3474834	LEVER
35	* U3474635	LEVER, WSM, HIGH WALL/TRADITIONAL
36	* B3474838	LEVER LATCH BALL
37	* B3474840	LEVER LATCH BALL SPRING
38	* B3474836	LEVER PIN
40	* B3474848	LINK PIN
41	* B3474848	LINK LEVER PIN
42	* B3474852	MAINSRING
43	* B3474855	MAINSRING GUIDE
44	* B3474857	MAINSRING GUIDE RETAINER (FRONT)
45	* B3474861	MAINSRING GUIDE RETAINER (REAR)
46	B3474865	SCOPE MOUNT FILLER SCREWS
49	* B3474880	FRONT SIGHT, 45-70
49	* B3474650	FRONT SIGHT, TRADITIONAL, 30-30 (53W)
49	* B3474649	FRONT SIGHT, TRADITIONAL, 38-55 (45W)
50	* B3474881	REAR SIGHT APERATURE, 45-70

Ref. #	Part #	Description
50	* B3474652	REAR SIGHT APERATURE, TRADITIONAL
51	B3474882	REAR SIGHT ELEVATOR , 45-70
51	B3474656	REAR SIGHT ELEVATOR TRADITIONAL, 38-55 (4.6MM)
51	B3474945	REAR SIGHT ELEVATOR, 454 CASULL
51	B3474655	REAR SIGHT ELEVATOR, TRADITIONAL, 30-30/45-70
52	* U3474656	STOCK, BPCR TARGET (SHOT SHOW '09)
52	* U3474659	STOCK, CREEDMOOR (DAVIDSON'S)
52	* U3474634	STOCK, WSM, HIGH WALL/TRADITIONAL
53	B3474895	STOCK BOLT LOCK WASHER
54	B3474893	STOCK BOLT
55	B3474896	STOCK BOLT WASHER
56	B3474897	STOCK SLING EYELET
60	B3474938	TRIGGER HOUSING PIN
61	* B3474876	SEAR SPRING PIN
61	* B3474907	TRIGGER PIN/SEAR PIN
62	* B3474923	TRIGGER PULL ADJ. SCREW
65	* B3474912	TRIGGER SPRING
45A	B3474734	BUTT PLATE, BPCR
45A	B3474624	BUTT PLATE, TRADITIONAL
45A	B3474944	BUTT PLATE, TRADITIONAL (COLOR CASE HARDENED)
45A	U3474655	RECOIL PAD
	B3474623	FRONT SIGHT, ADJ BASE
	B3474622	FRONT SIGHT, ADJ BASE SPRING
	B3474626	FRONT SIGHT, ADJ LOCK COLLAR
	B3474627	FRONT SIGHT, ADJ SIGHT BODY & TUBE
	B3474621	FRONT SIGHT, ADJ THREAD BOSS
	B3474630	FRONT SIGHT, ADJ WIND LOCK KNOB
	B3474629	FRONT SIGHT, ADJ WIND SCREW & KNOB
	B3474821	GRIP CAP PIN
	B3474820	GRIP CAP SCREW, BPCR
	B3474683	REAR SIGHT ELEVATOR SCREW LOCKING COLLAR
	B3474688	REAR SIGHT LADDER ASSEMBLY, BPCR
	B3474696	REAR SIGHT WINDAGE BASE MOUNT SCRW, BPCR
	B3474695	REAR SIGHT WNDAGE BASE SPRING, STD
	B3474689	REAR SIGHT WNDAGE LOCK KNOB SCREW, BPCR
	B3474690	REAR SIGHT WNDAGE LOCK KNOB, BPCR
	B3474694	REAR SIGHT WNDAGE SCREW, BPCR
	B3474691	REAR SIGHT WNDAGE SPRING WASHER, BPCR
	B3474984	TANG SCREW NUT, BPCR
	B3474982	TANG SCREW, BPCR
	B3474660	TANG SIGHT APERATURE, TRADITIONAL
	B3474665	TANG SIGHT ASSEMBLY, TRADITIONAL
	B3474697	TANG SIGHT BASE, BPCR
	B3474686	TANG SIGHT DISC, #60, BPCR
	B3474685	TANG SIGHT DISC, #70, BPCR
	B3474670	TANG SIGHT MOUNT SCREW, TRADITIONAL

Additional parts are available by contacting our parts department.
1-800-322-4626 x3

*Indicates part must be fitted by Winchester Repeating arms Service Department or qualified gunsmith.
**Factory installation only - Return firearm for installation.
+Part may be purchased only by holders of current, valid Federal Firearms License.
NOTE: unless otherwise indicated, part is interchangeable between gauges/calibers.

Winchester Gun Parts Price List

Lever Action Rifle



Model 1885 High Wall

NOTE: WHEN ORDERING PARTS, USE THE PART NUMBER AND NOT THE SCHEMATIC REFERENCE NUMBER.

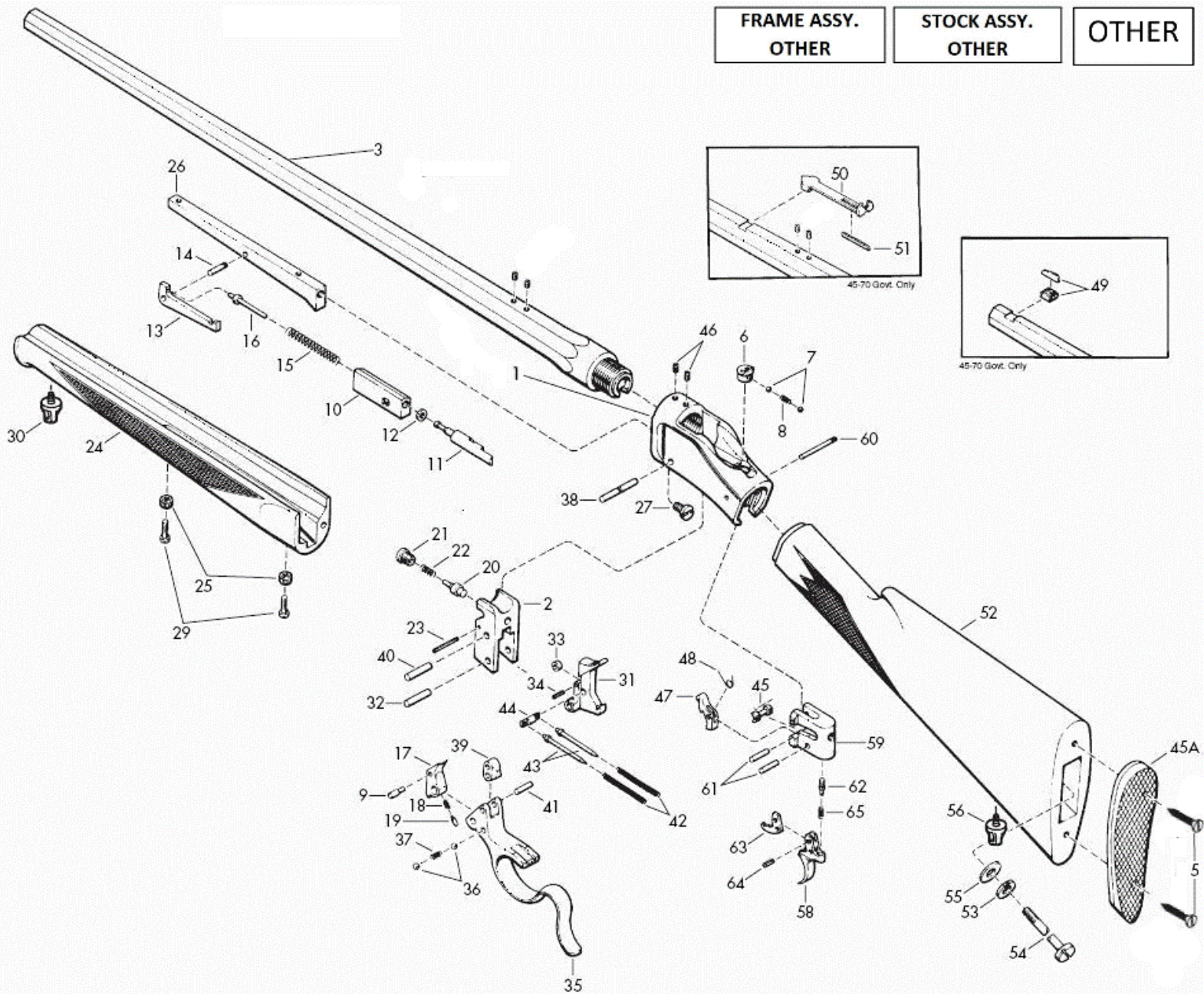

1885 HW

Schematic is provided for parts identification only and should not be used as a guide to assemble guns.
CAUTION: Winchester parts are not recommended for use in other guns though models may be similar.
Inadequately fitted parts may be dangerous.

Winchester Gun Parts Price List